

Programming for a Healthy Future: Two School Districts' Path to Equitable Learning

Kurt Schultz, Ed.D.

Principal, Lakeridge Middle School,
Lake Oswego School District

Taine Wilton, AIA, ALEP, LEED AP

Capital Projects Manager,
Edmonds School District

Abby Dacey AIA LEED AP

Mahlum Architects

Corrie Rosen AIA LEED AP

Mahlum Architects

Introduction

WHY is it important to take the time to reconsider distinct spatial solutions for modern learning environments?



30 feet x 30 feet

30 students

30 sf/student

Lakeridge Middle School, Lake Oswego Oregon



Madrona K-8, Edmonds, Washington





Kurt Schultz, Ed.D.
Principal,
Lakeridge Middle School
Lake Oswego School
District



Taine Wilton
AIA, ALEP, LEED AP
Capital Projects Manager
Edmonds School District



Abby Dacey
AIA LEED AP
Mahlum Architects



Corrie Rosen
AIA LEED AP
Mahlum Architects

Agenda

Transformational Questions

Interactive Programming Exercise

Design Solutions + Outcomes

Conclusions + Questions

Learning Objectives

AIA Learning Units: Health Safety and Welfare

- > Discover **programming tools** to inform a building design solution centered around teaching and learning activities rather than traditional metrics.
- > Hear a principal, capital projects manager, and architect explain **how programming impacted classroom design and professional development** for staff.
- > Learn to articulate ways to **equitably support the learning center** and identify resources and tools, including appropriate acoustics and daylighting.
- > Consider how natural ventilation, air filtration, sinks, moveable walls, and inclusive restrooms facilitate the **adjustment to a post-Covid world**.

Transformational Questions

Lakeridge Middle School

**How might we support
every learning experience
to be interactive, creative,
and adaptable?**

Madrona K-8

**How can we center
multi-age and outdoor
learning and support
variety in collaborative
learning?**

Interactive Portion

Programming Tools

Environmental Psychology

How Learning Environments Shape Our Lives

- > *Welcome to Your World:
How the Built Environment Shapes Our Lives*
by Sarah Williams Goldhagen

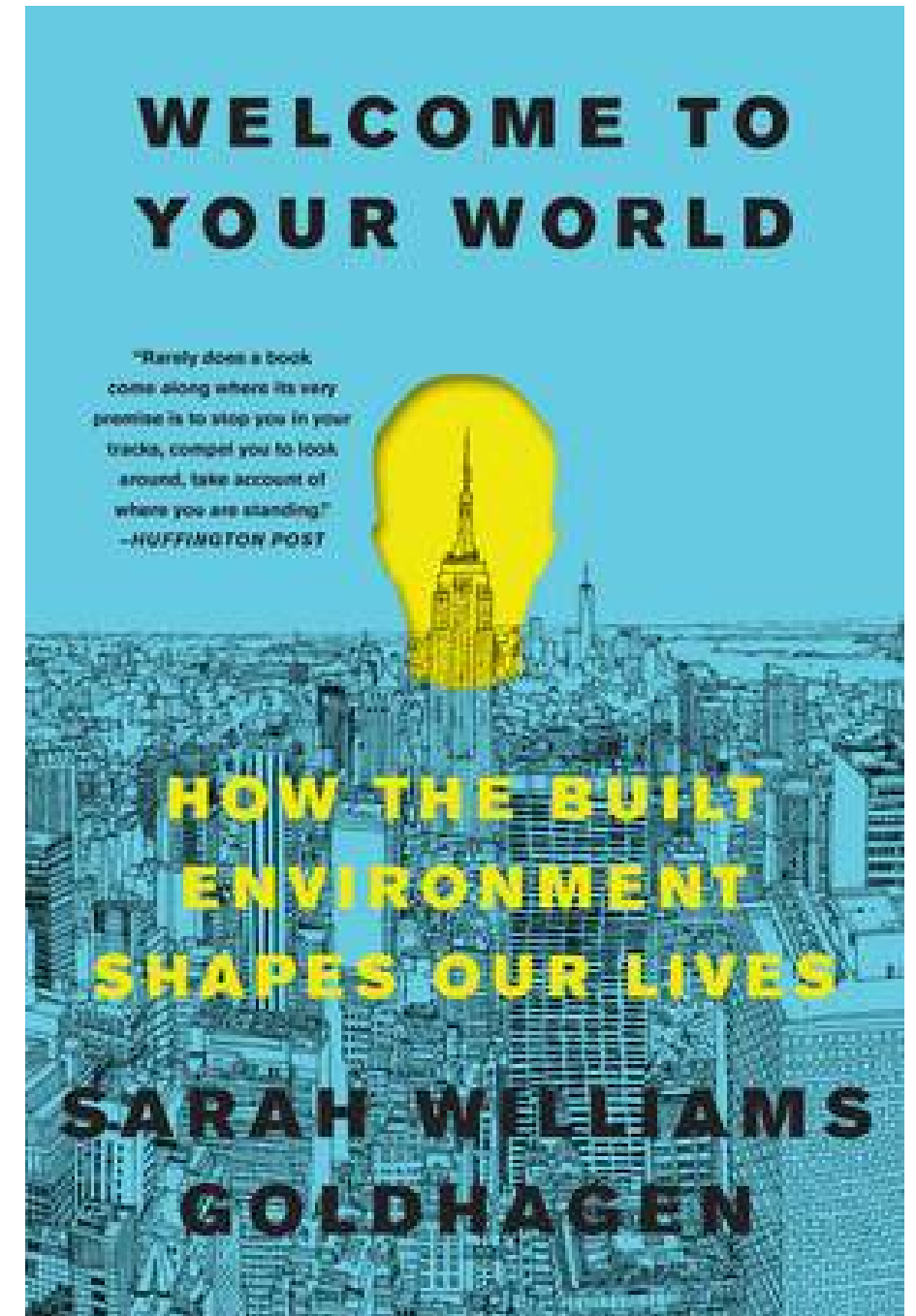

Affordances

- > "The affordances of the environment are what it offers the animal, **what it provides or furnishes**, either for good or ill."
James J. Gibson, 1979
- > "... the properties of an object or features of an environment that **suggest to us how it is to be used.**"
Sarah Williams Goldhagen, 2017
- > **Implies a relationship between the animal and the environment**
- > **Examples:**
Seat walls, cushions, furniture



Action Settings

- > **Three Components:**
 - Person
 - Environment
 - Social Context
- > Action spaces as predictors of **children's behavior**
(Roger Barker)
- > **Patterned arrangement and social context**
(Sarah Williams Goldhagen)



Action Settings

Questions to Consider

Sarah Williams Goldhagen's criteria for how we engage with a particular place:

- > How does it facilitate human activities and the correspondence among those activities?
- > What is the preferred arrangement of objects in space?
- > What associations do the place's forms elicit?



Action Settings / Learning Modalities

As an Educator:

- > How can the built environment support your academic program?
- > What would happen if we begin by programming space around action settings or learning activities instead of around desks?
- > What affordances or tools are needed to support these activities?

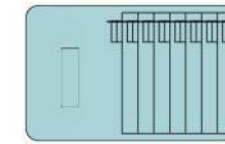

Forum/Lecture

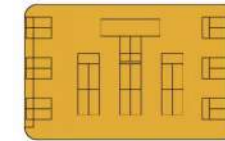

Workshop/Create

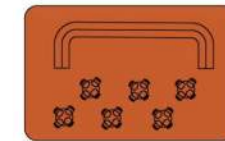

Community/Gather

GROUP ACTIVITY (<14 STUDENTS)



Project/Activity



Large Group



Small Group

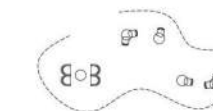

Individual Study



What's on Your Mind?

**Select an issue or goal
related to student-
centered learning that
you want to address at
your school.**

Action Settings / Learning Modalities

Actions

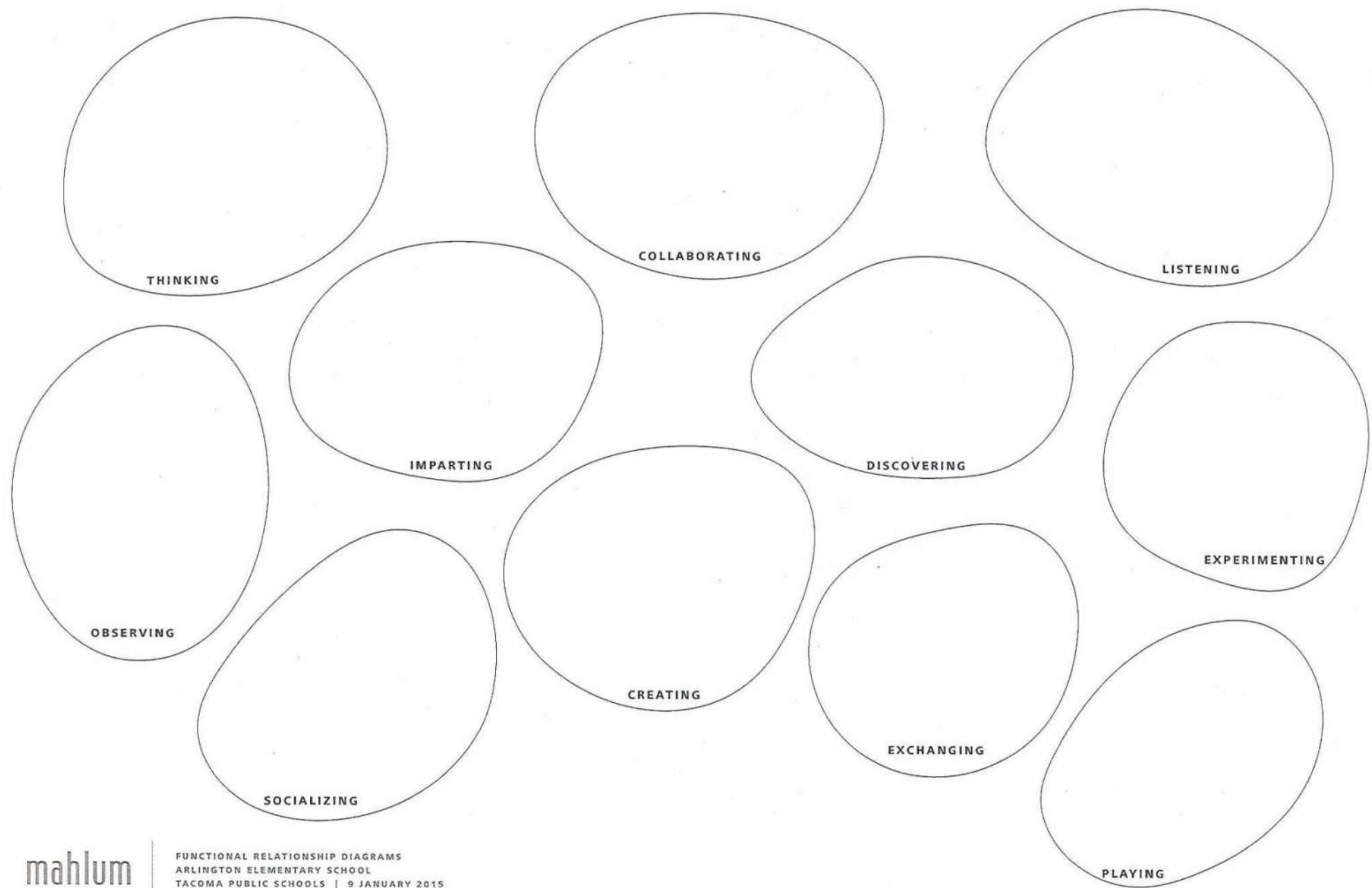

Action Settings / Learning Modalities

Student Groupings

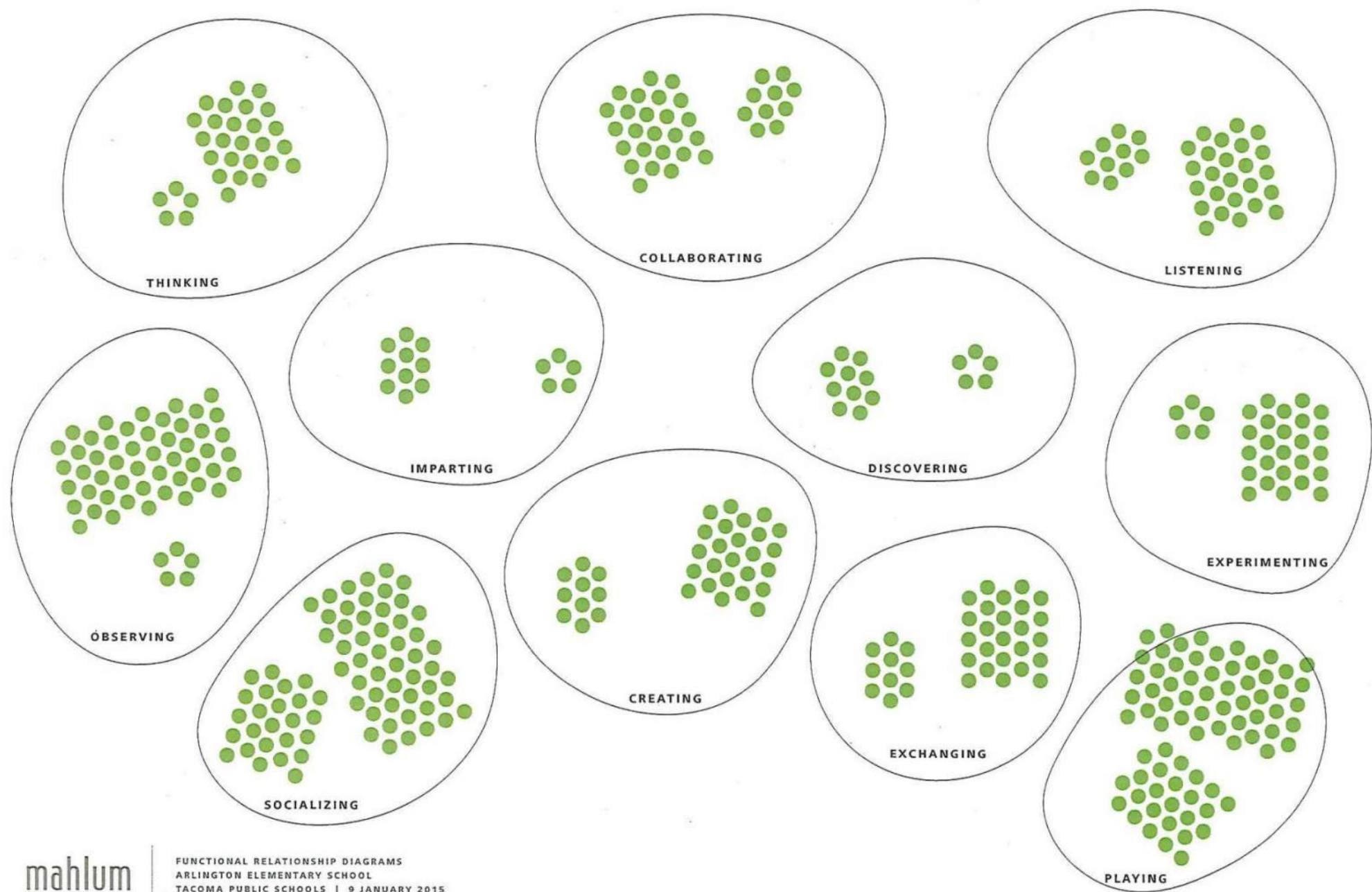

Action Settings / Learning Modalities

Affordances/Tools

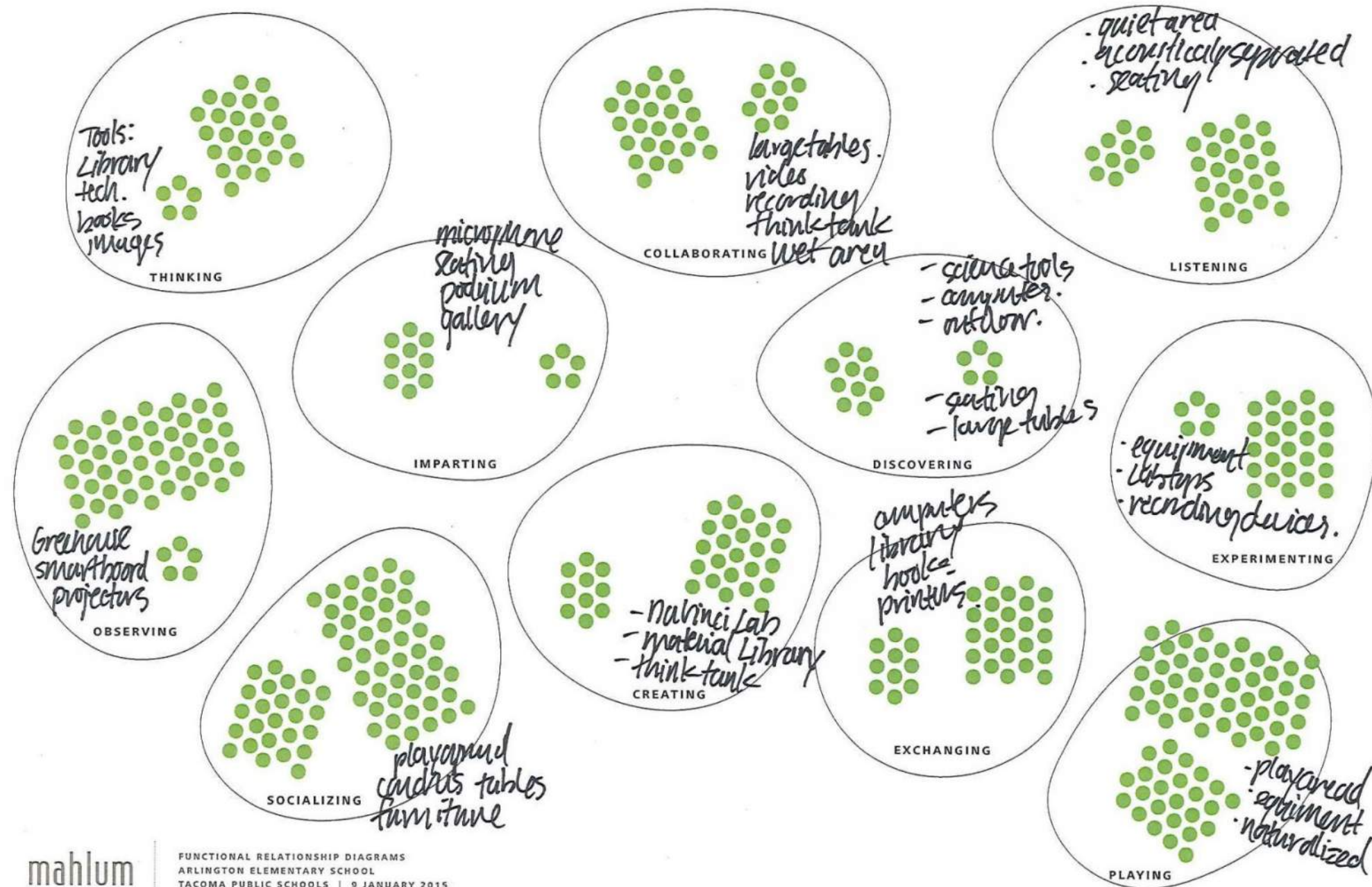

Action Settings / Learning Modalities

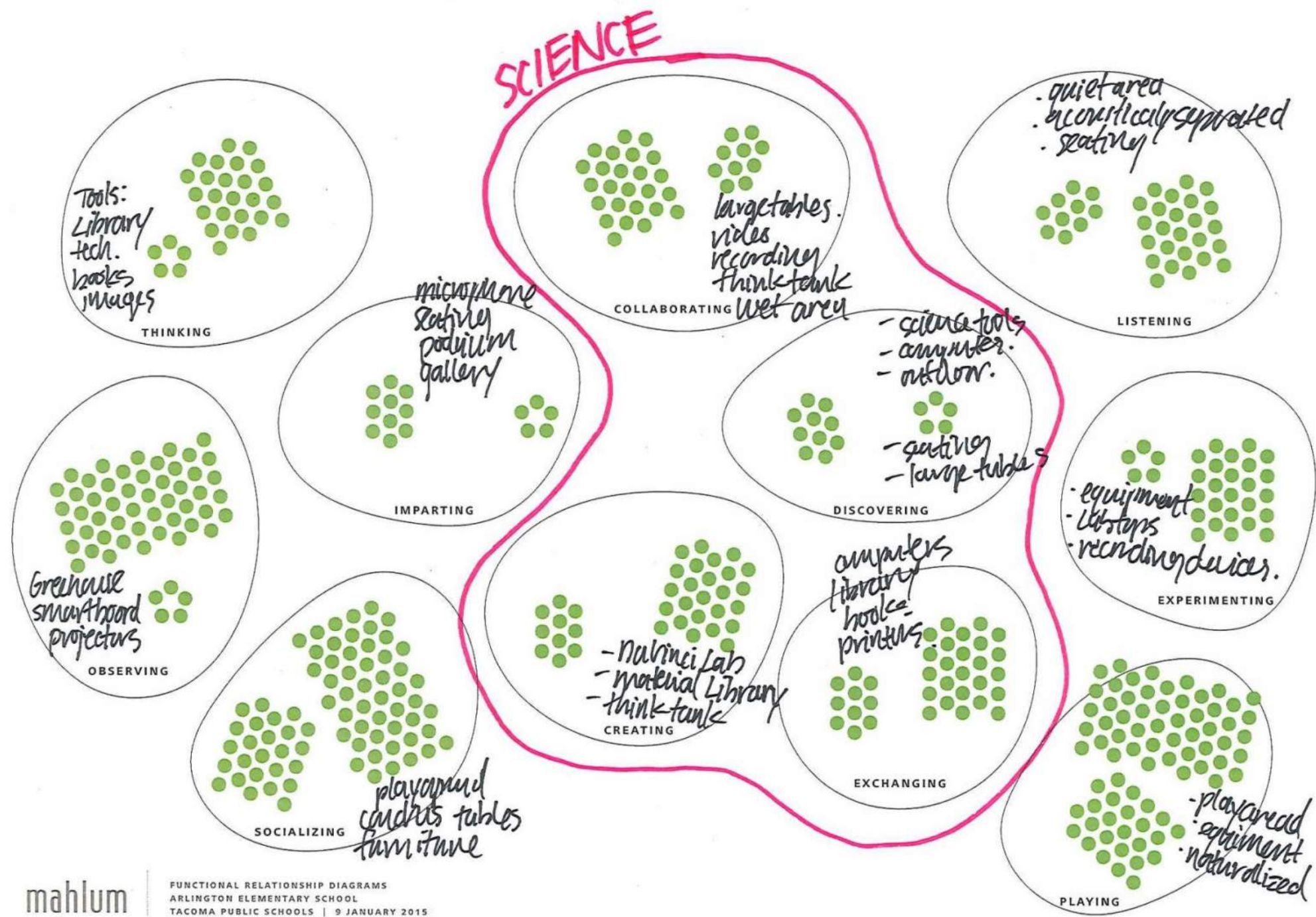

Action Settings / Learning Modalities

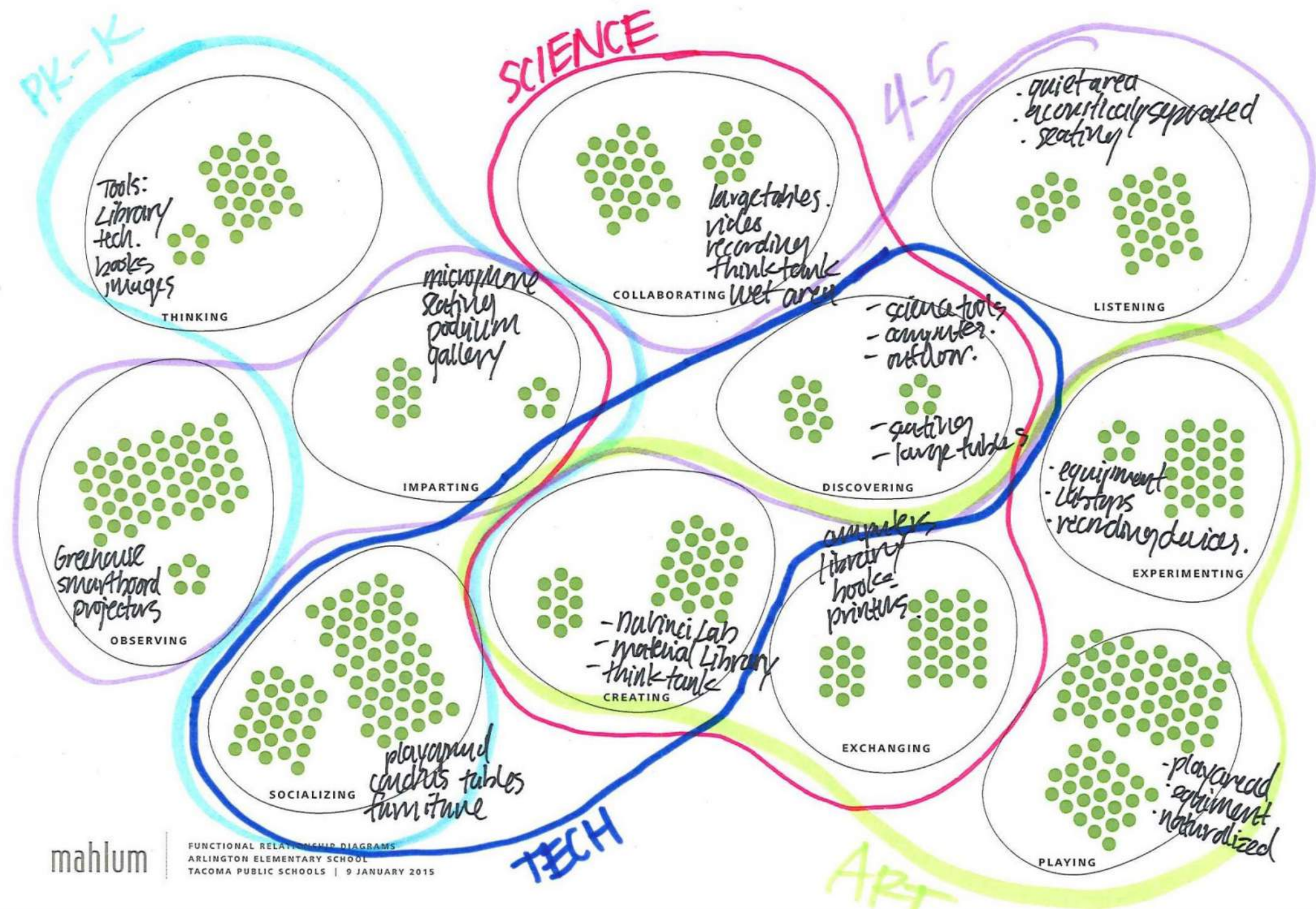

Topic Ideas

- > Student-centered classrooms
- > Push-in learning
- > Deep collaboration
- > Feeling safe in a post-pandemic school
- > Pick another based on your school's needs

Share Back

A-ha Moments

Design Solutions & Outcomes

Lakeridge Middle School

Design Solution + Outcomes

OWNER

Lake Oswego
School District

LOCATION

Lake Oswego,
Oregon

OCCUPANCY

2020

CAPACITY

1,100 Students

GRADES HOUSED

6-8

SITE AREA

28.8 Acres

BUILDING AREA

141,000 SF

BUDGET

\$68.6M

PREDICTED ENERGY USE

22 pEUI

ESTIMATED UTILITY SAVINGS

\$56,000/year

ARCHITECT

Mahlum Architects

GENERAL CONTRACTOR

Skanska

STRUCTURAL ENGINEER

KPFF Consulting
Engineers

CIVIL ENGINEER

HHPR

LANDSCAPE ARCHITECT

Mayer/Reed

MECHANICAL/ELECTRICAL

PAE

THEATER

PLA Designs

A/V & ELEVATOR

The Greenbusch Group

SECURITY & ACOUSTIC

Stantec

FOOD SERVICE

Halliday Associates

Design Tours

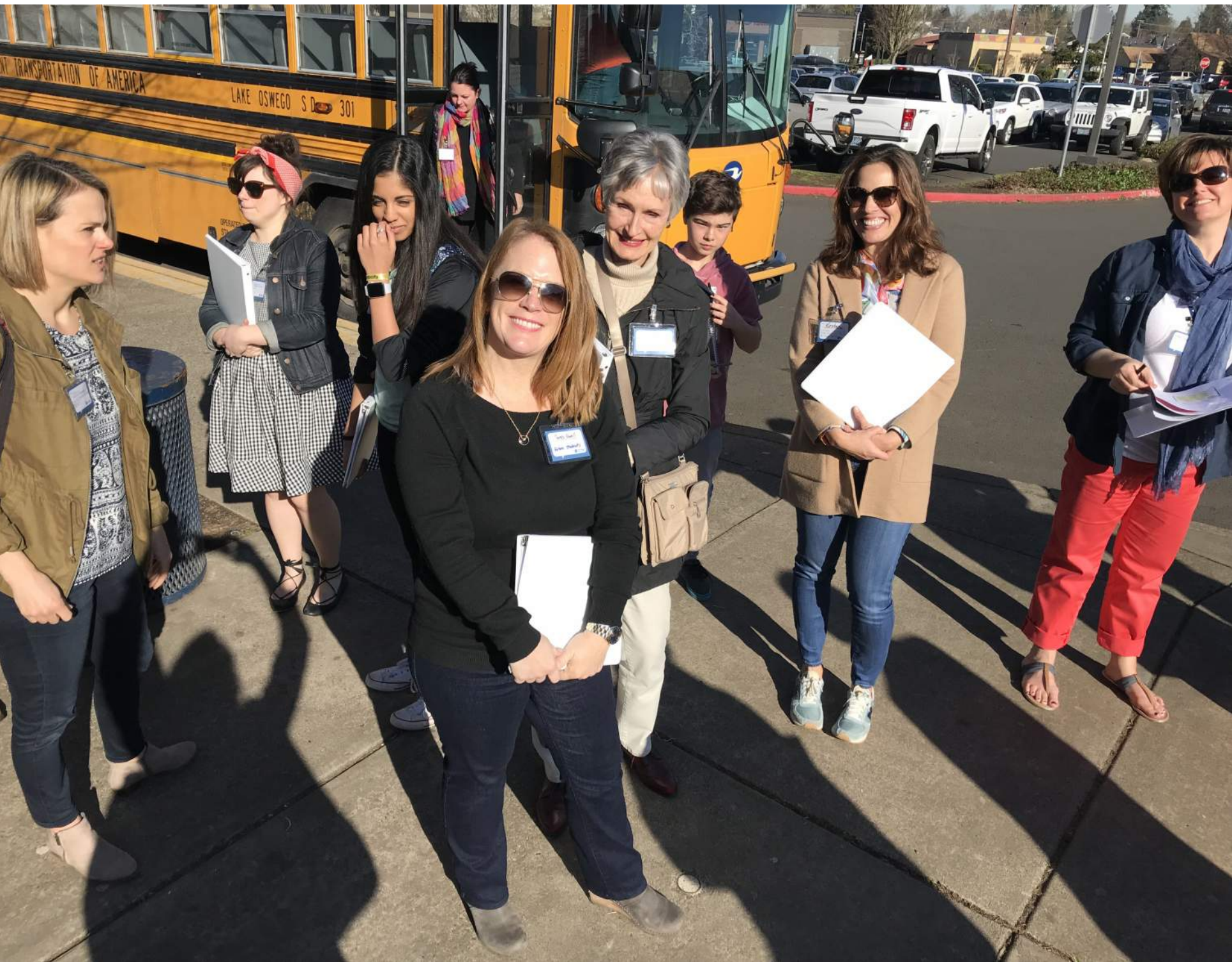

Learning Studios

1300 sf + 900 sf

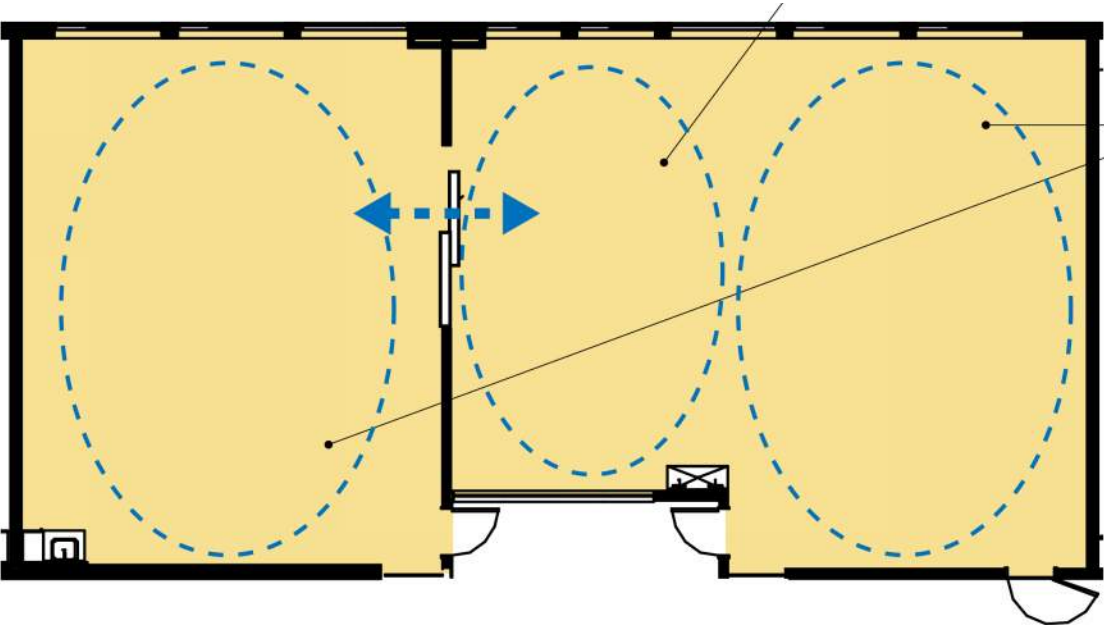

STANDARD CLASS



SMALL GROUP
BREAKOUT

HALLWAY

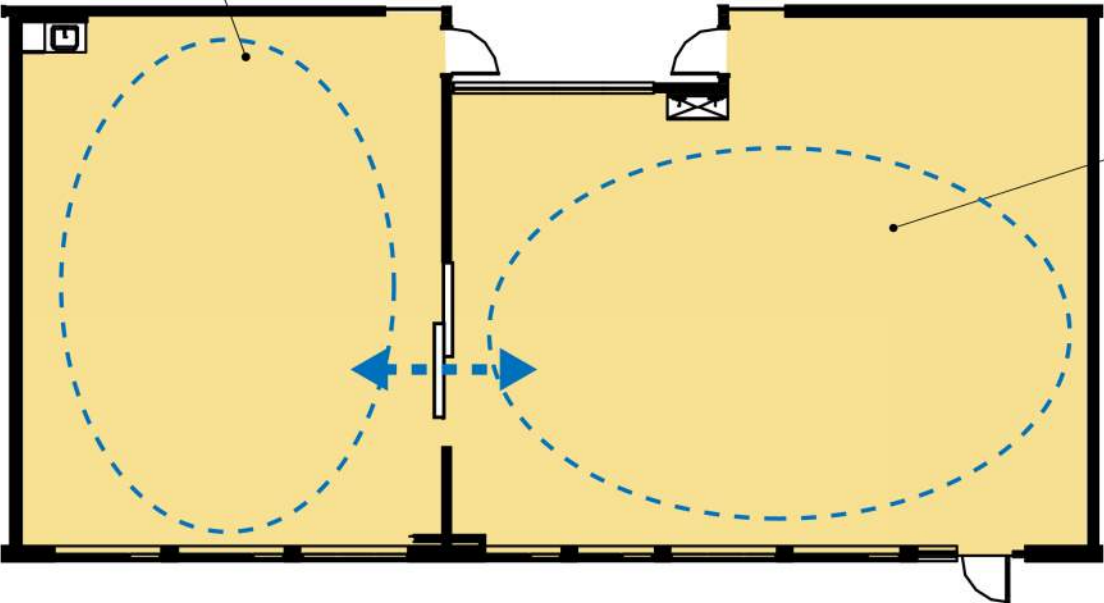

LARGE GROUP CLASS



Learning Studios

2 teachers, 1 learning environment

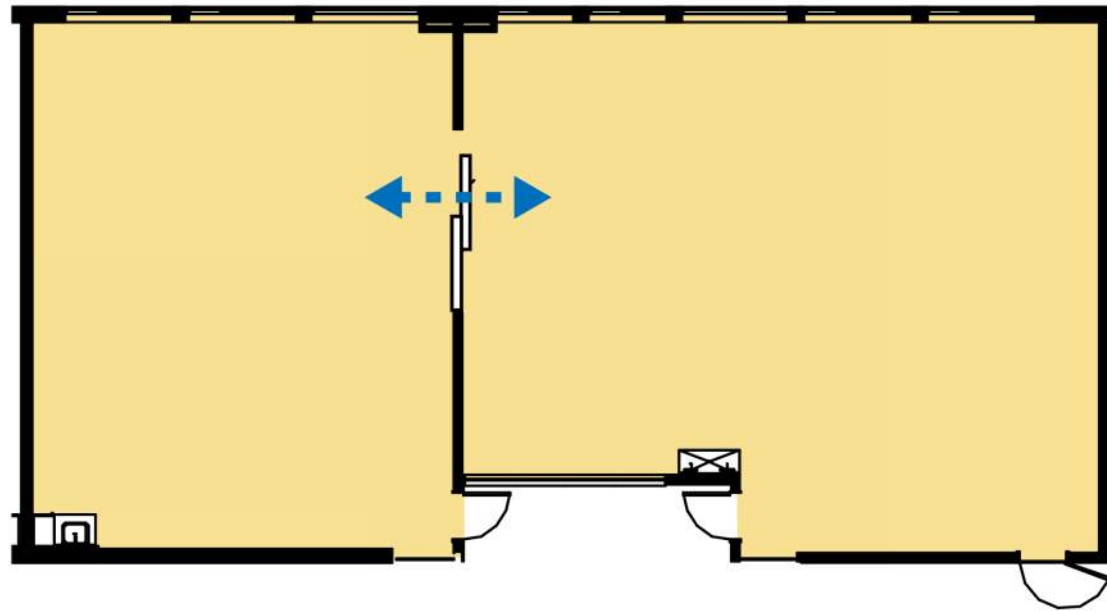

HALLWAY

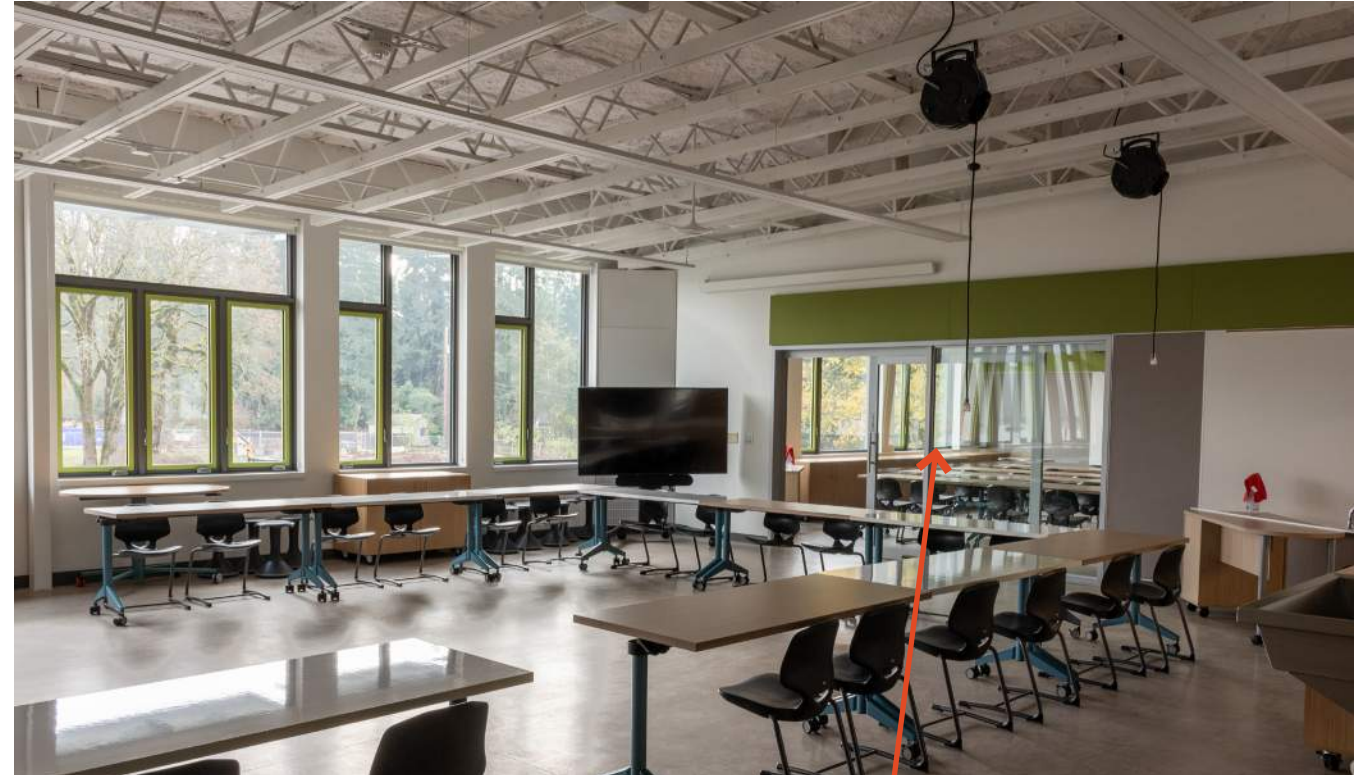
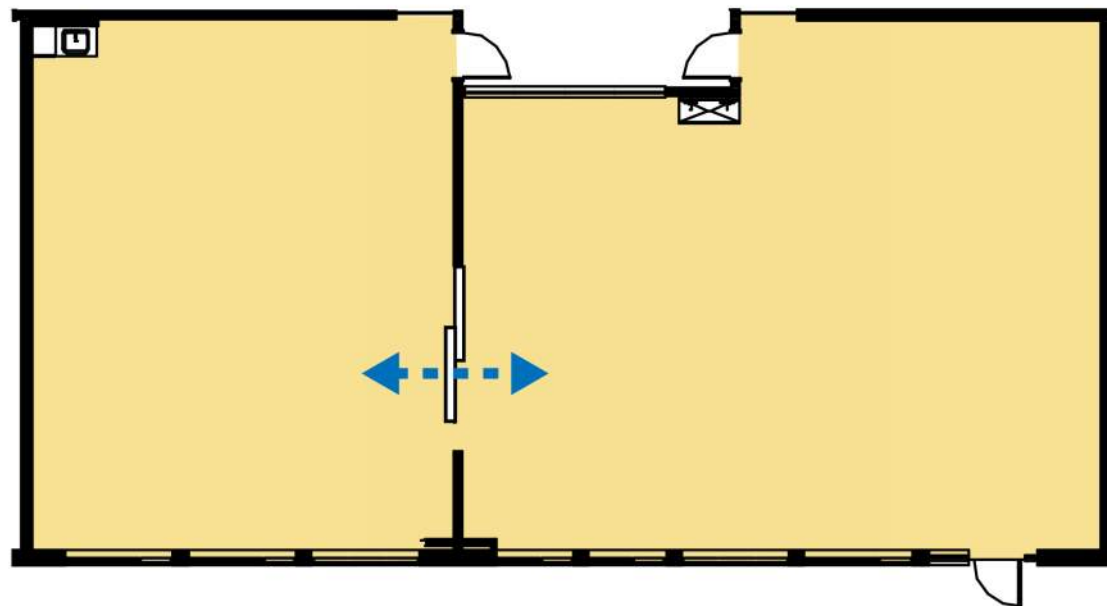

Learning Studios

Affordances (support tools)



HALLWAY

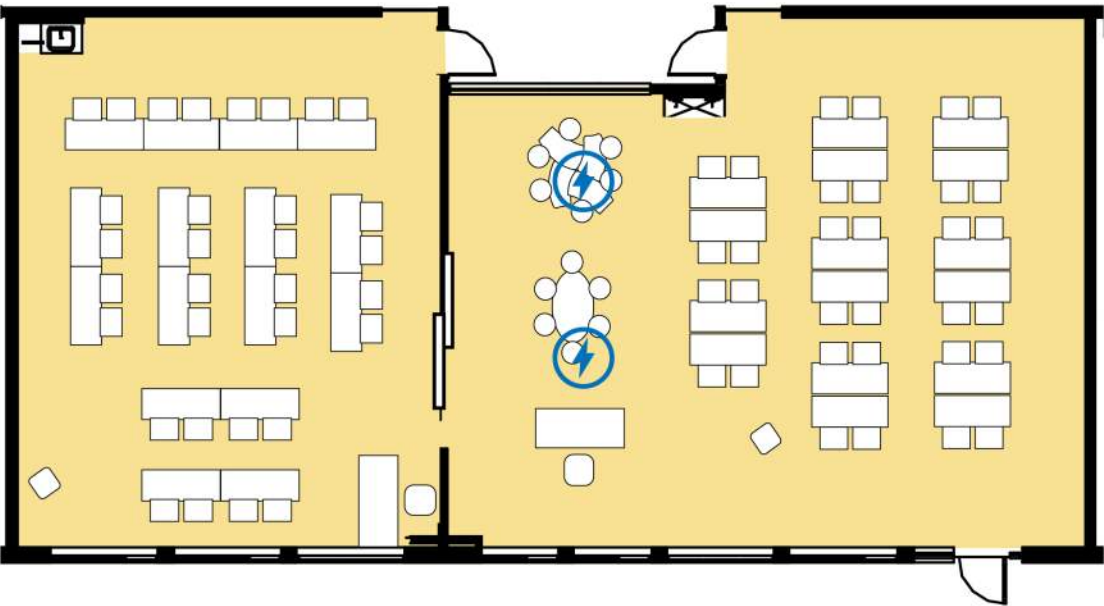

Learning Studios

In Action



Learning Spaces

LEVEL 1

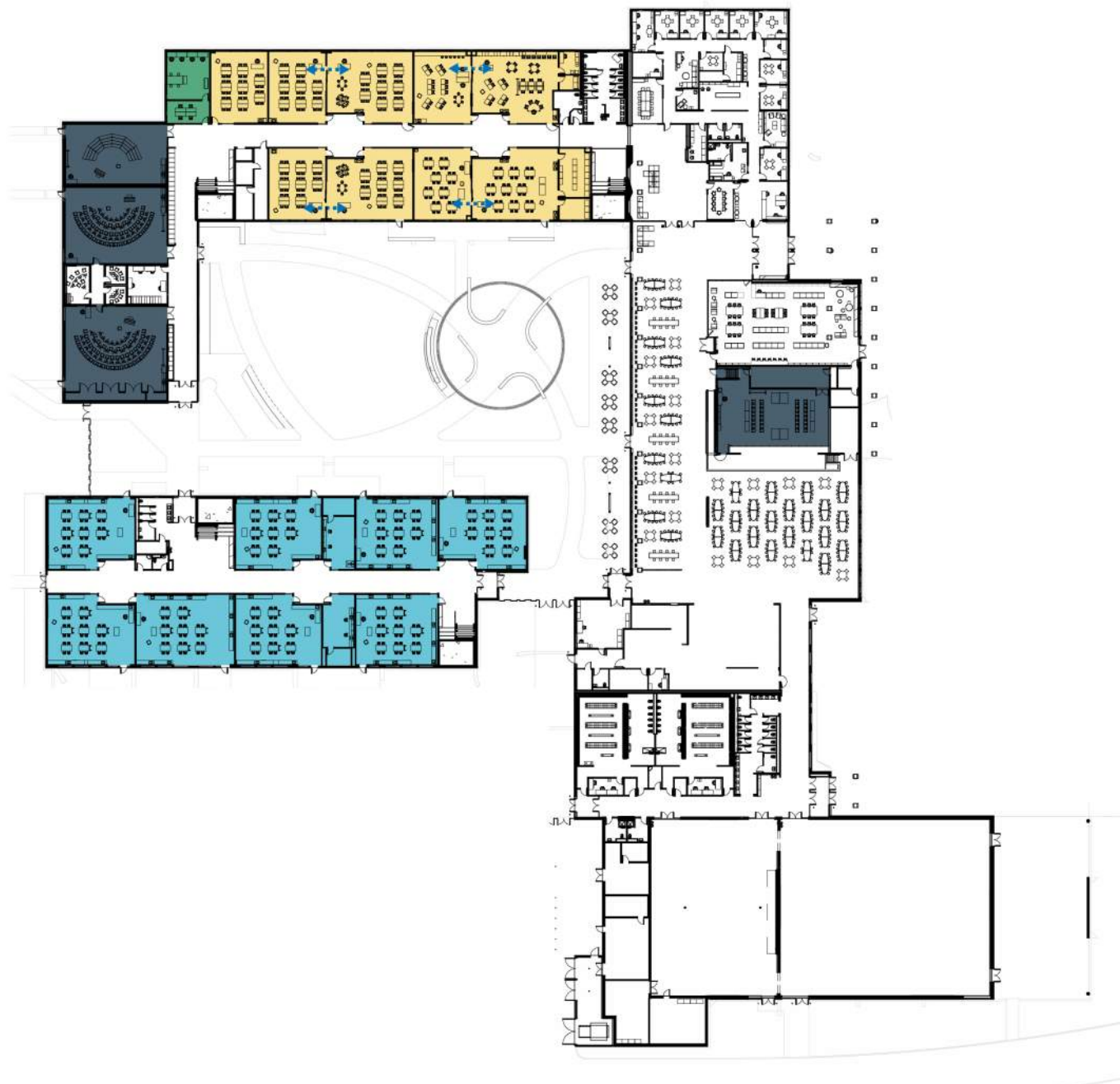

LEVEL 2

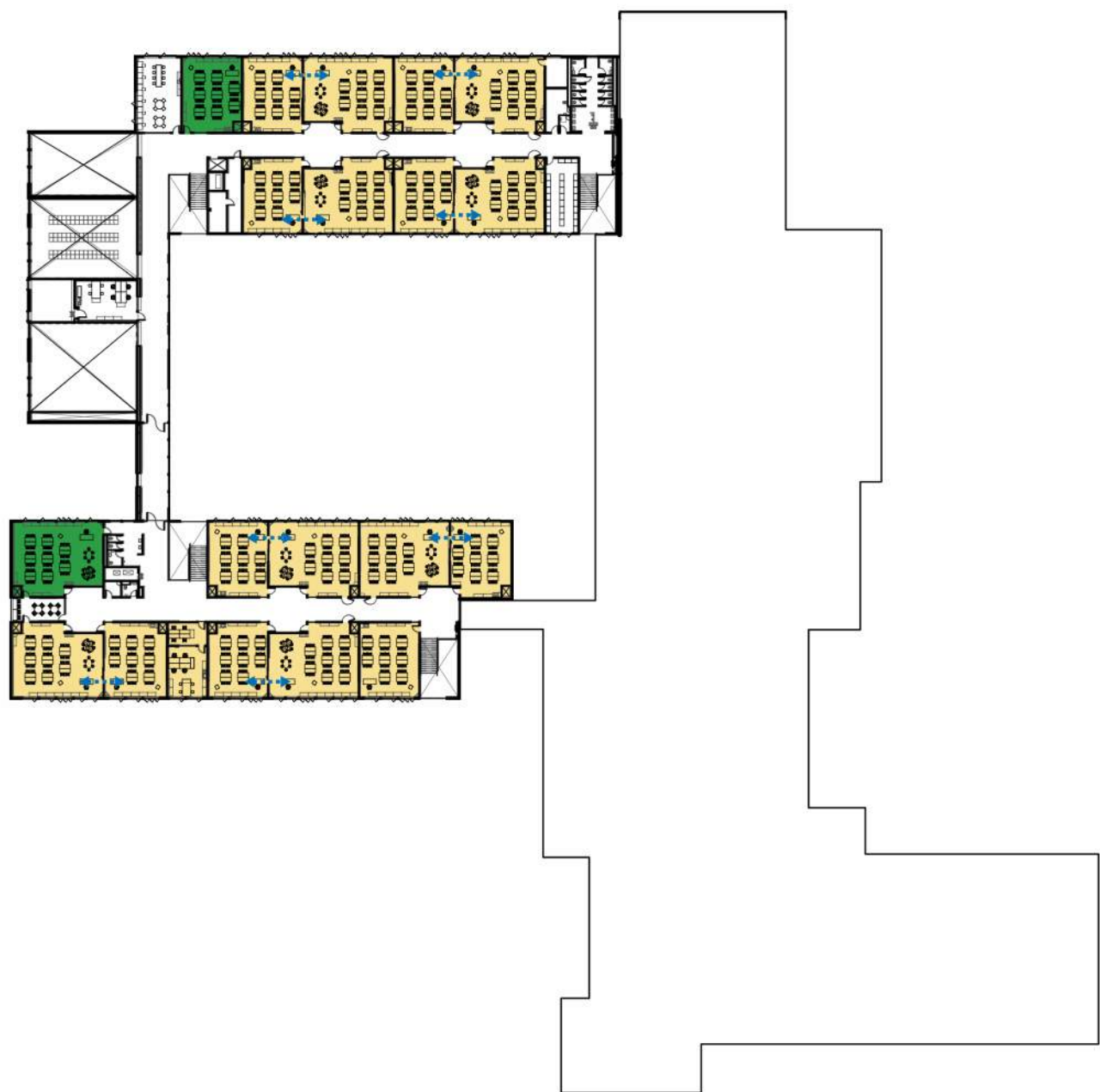

- Paired Learning Studios
- Single Learning Studio
- Dedicated Science Classroom
- Music and Drama

Hybrid Passive Cooling

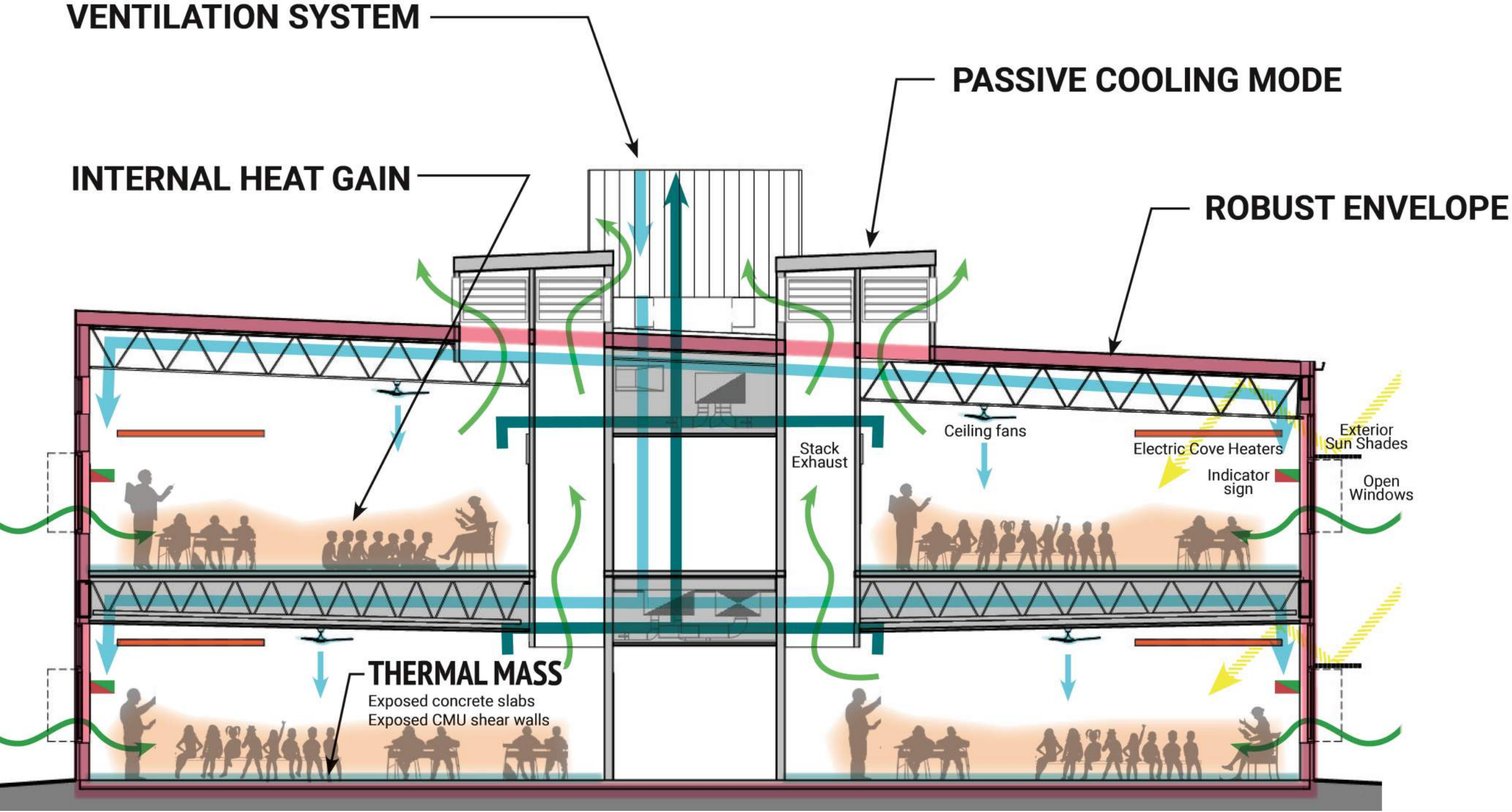



Biophilia: Gymnasia

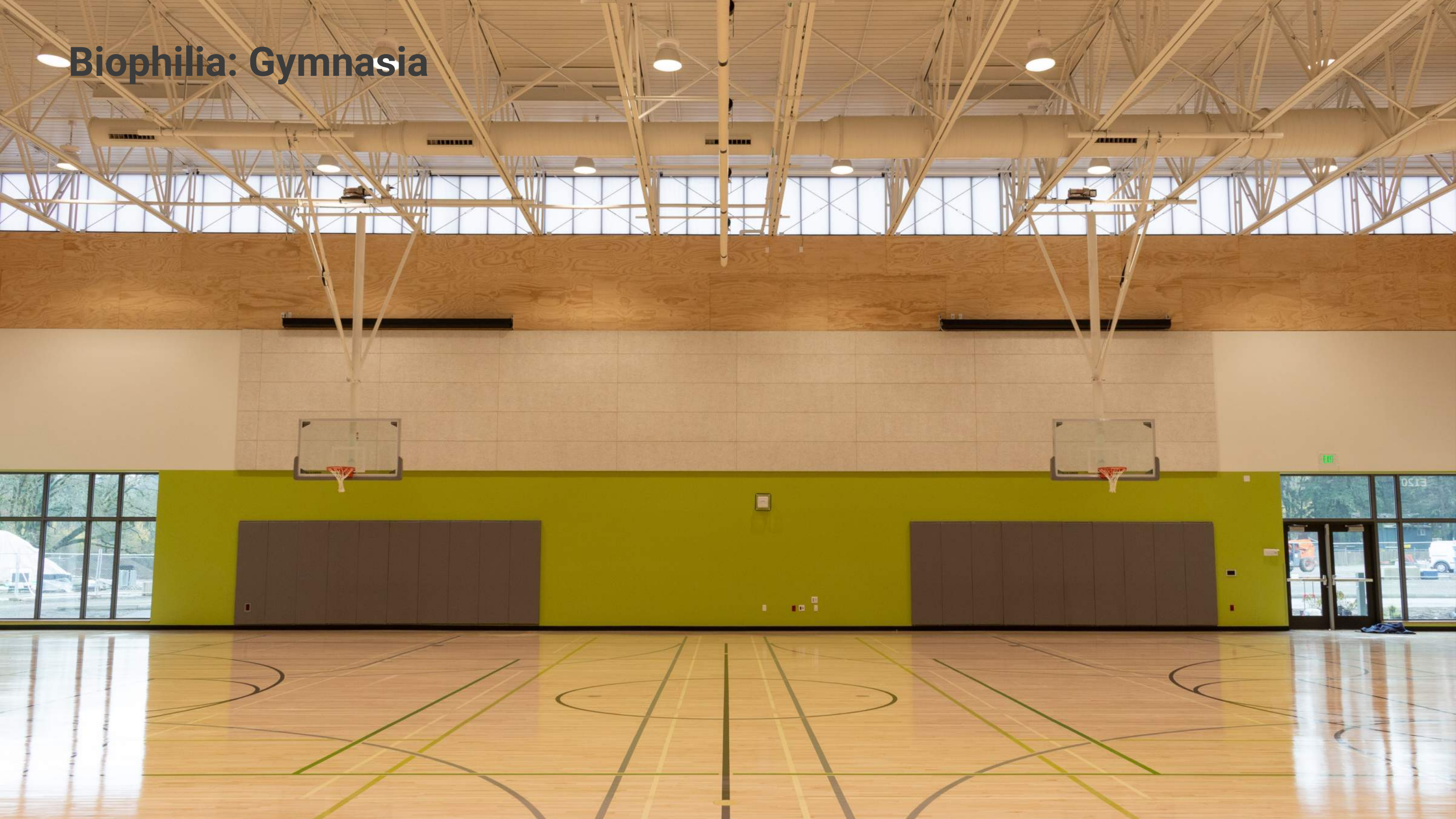

Biophilia: Whole Trees Columns





LAKERIDGE MIDDLE SCHOOL

Supporting Learning





Professional Development: Mockup Classroom



Professional Development: New Building





Madrona K-8

Design Solution + Outcomes

OWNER Edmonds School District	SITE AREA 14 Acres	ARCHITECT Mahlum Architects	LANDSCAPE ARCHITECT Cascade Design Collaborative
LOCATION Edmonds, Washington	BUILDING AREA 80,000 SF	GENERAL CONTRACTOR Forma Construction Company	MECHANICAL/ELECTRICAL Metrix Engineers
OCCUPANCY January 2019	BUDGET \$35.7M	STRUCTURAL ENGINEER Coughlin Porter Lundeen	ELECTRICAL ENGINEERS TFWB Engineers
CAPACITY 650 Students	PREDICTED ENERGY USE 36.6 pEUI	CIVIL ENGINEER KPFF Consulting Engineers	ACOUSTICS A3 Acoustics
GRADES HOUSED K-8			FOOD SERVICE Halliday Associates

Learning Centers

Multi-age K-8

- > 54 Students,
Grades 1-3 and 4-6
- > 2 Educators
- > Includes Regional Deaf
and Hard of Hearing
Program (DHH)

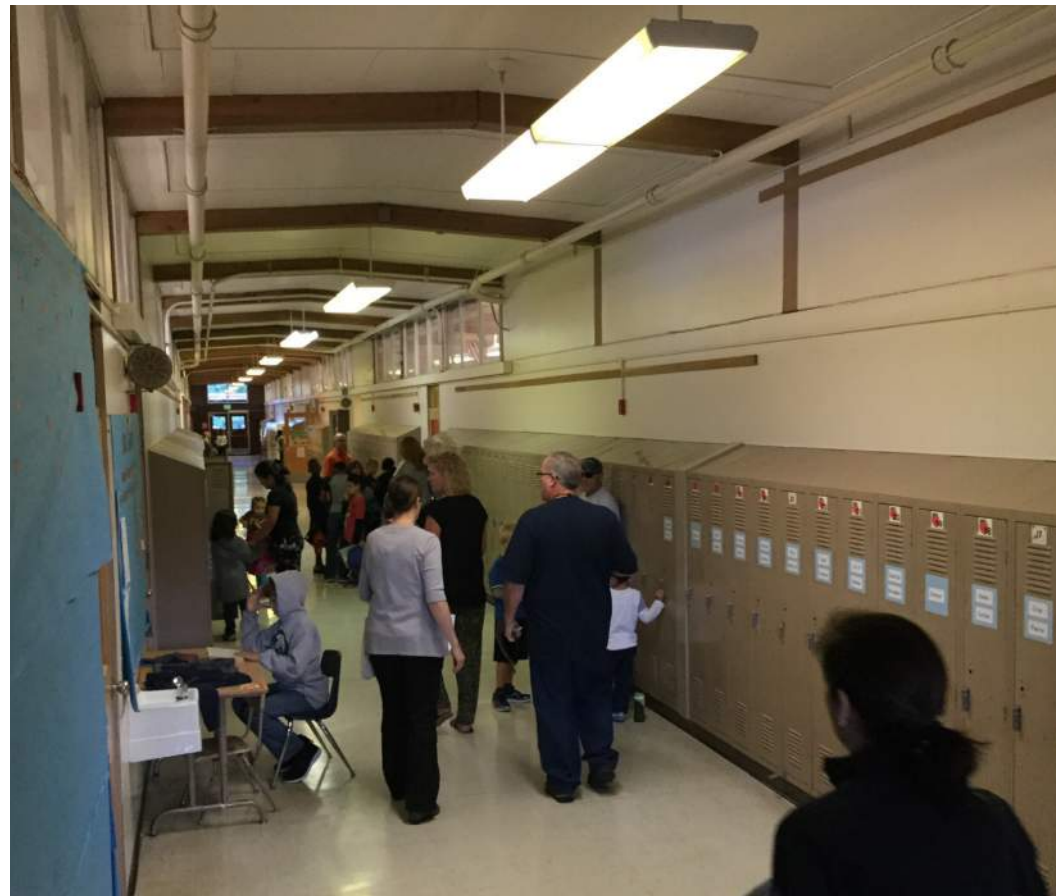

Outdoor Learning & Fresh Air

Student Voice

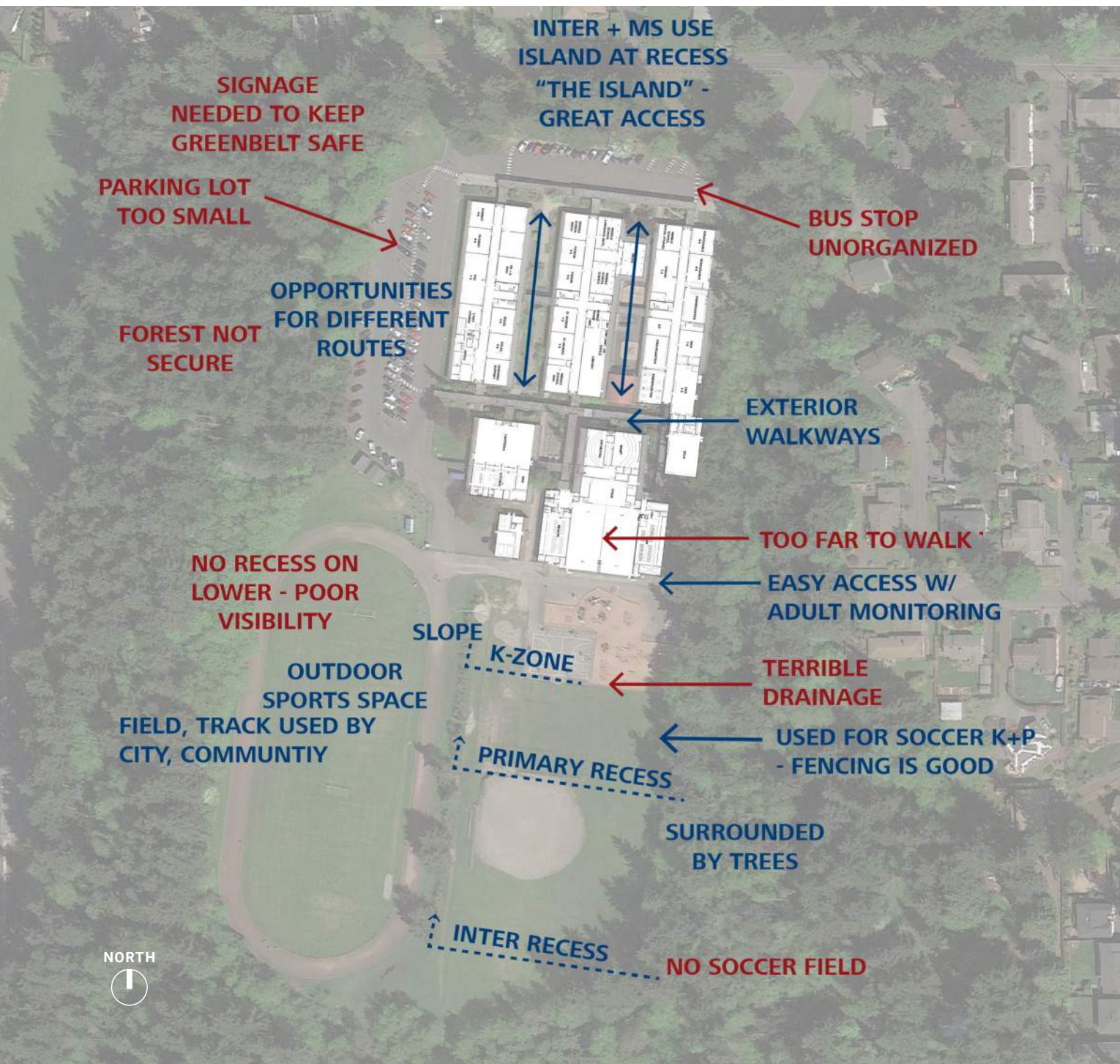

Functional Programming

Collaborative Learning at Multiple Scales - Indoor/Outdoor

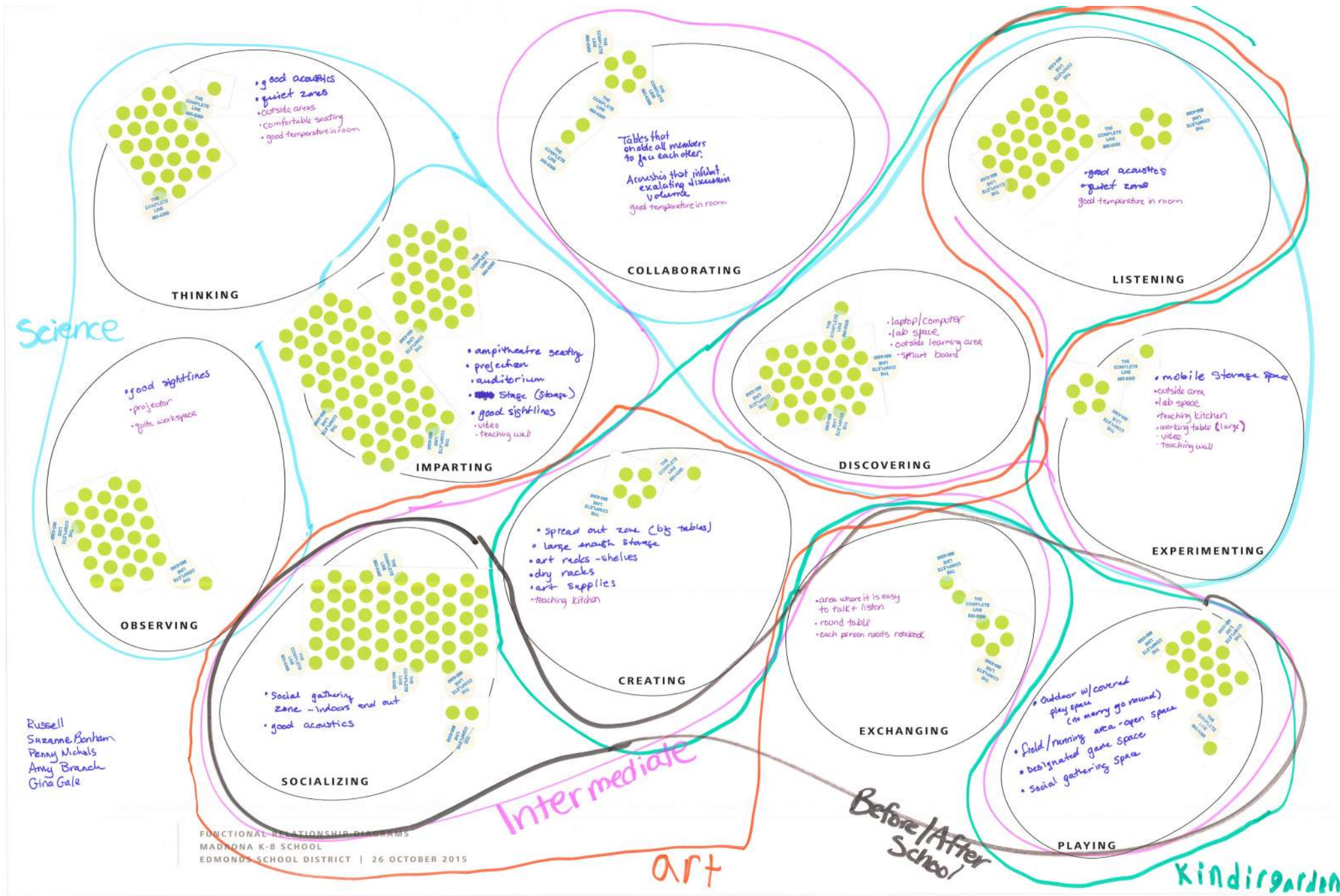

30%

FULL-CENTER/HALF-CENTER ACTIVITY

- Forum/Lecture
- Workshop/Create
- Community/Gather

70%

GROUP ACTIVITY (<14 STUDENTS)

- Project/Activity
- Large Group
- Small Group
- Individual Study

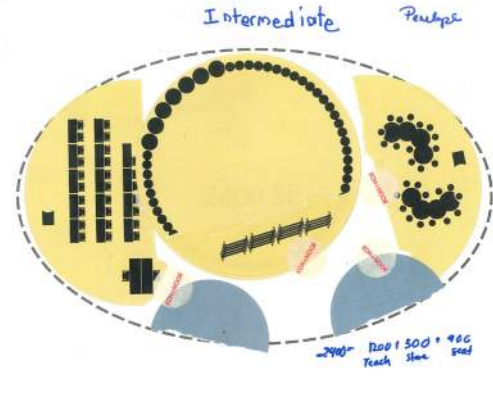
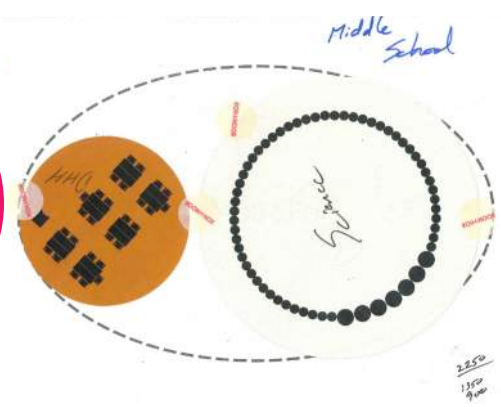
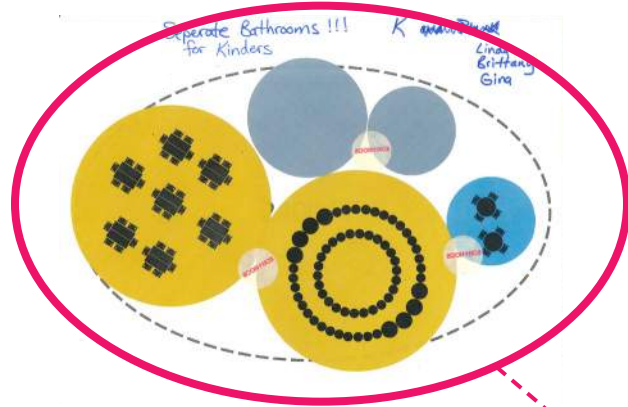

PRIMARY/INTERMEDIATE

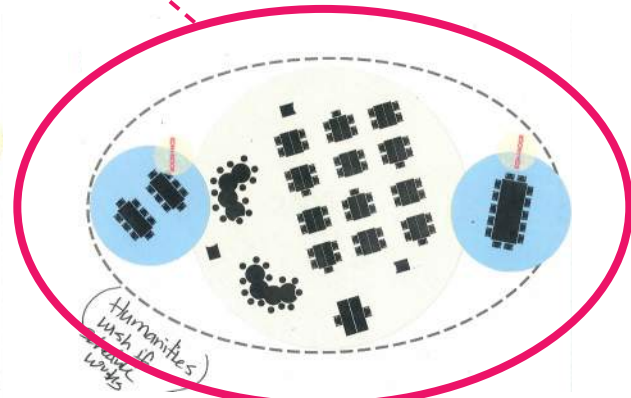
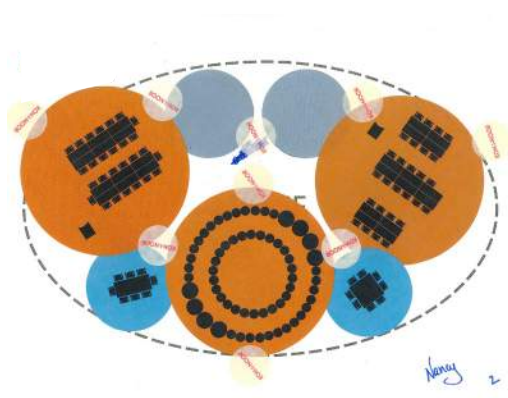

KINDERGARTEN
DHH PRIMARY/INTERMEDIATE
MIDDLE SCHOOL

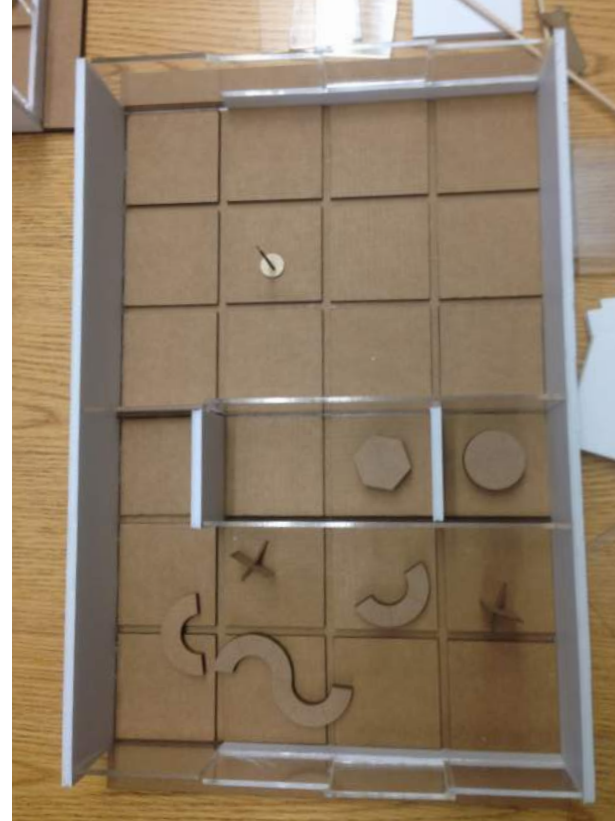
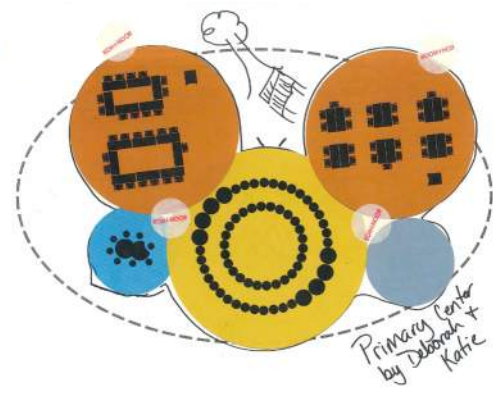
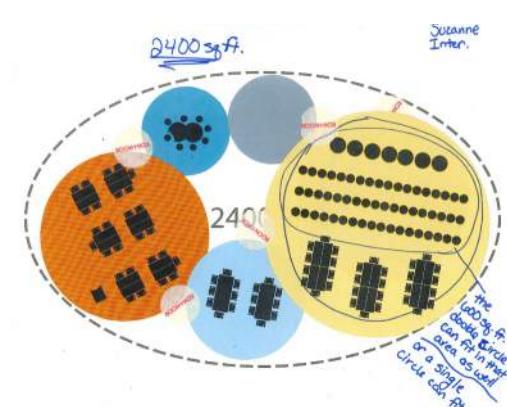
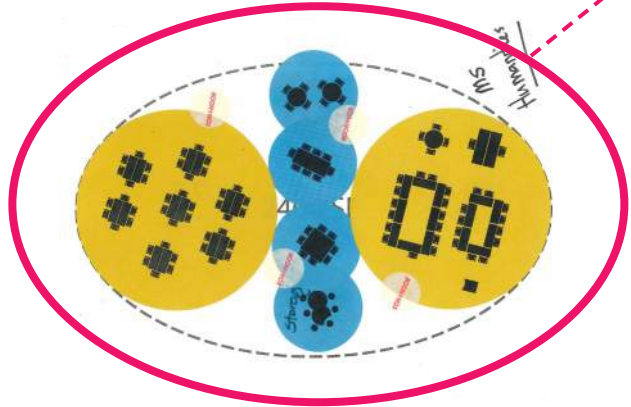

Developmentally Appropriate Centers



Kindergarten

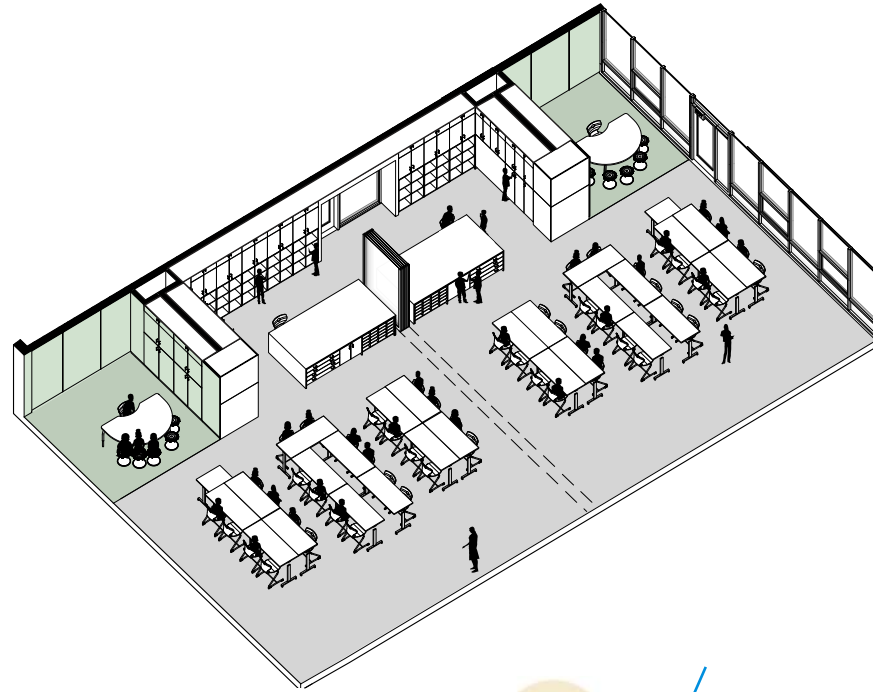

Primary /
Intermediate

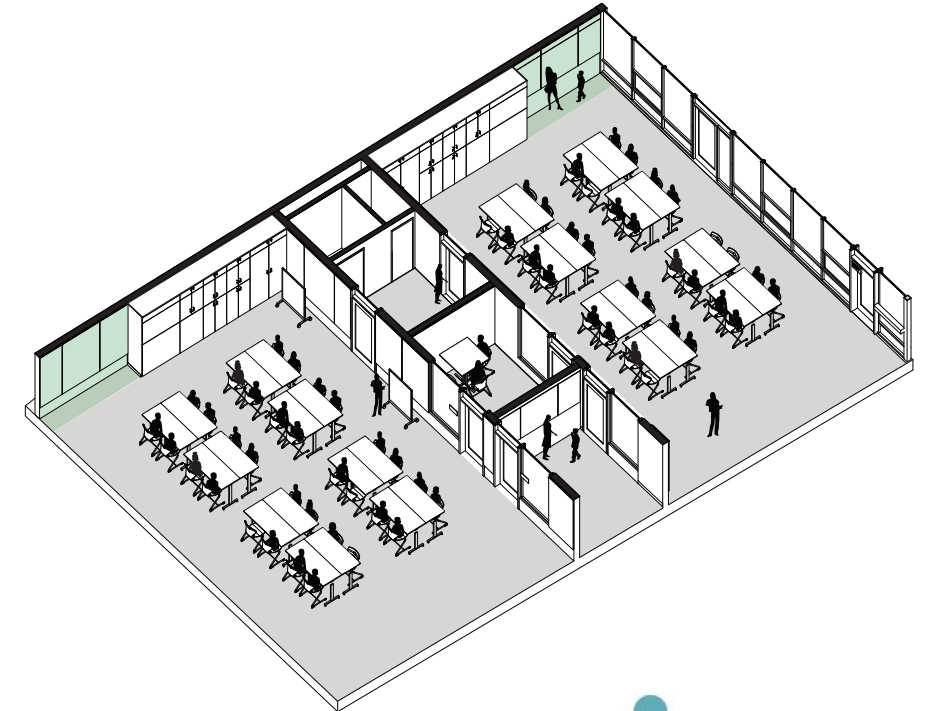

Primary /
Intermediate DHH
and
Middle School

Flexible Learning Environments

Inclusive Toilet Rooms



FLOOR PLAN:
LEARNING CENTER TOILETS

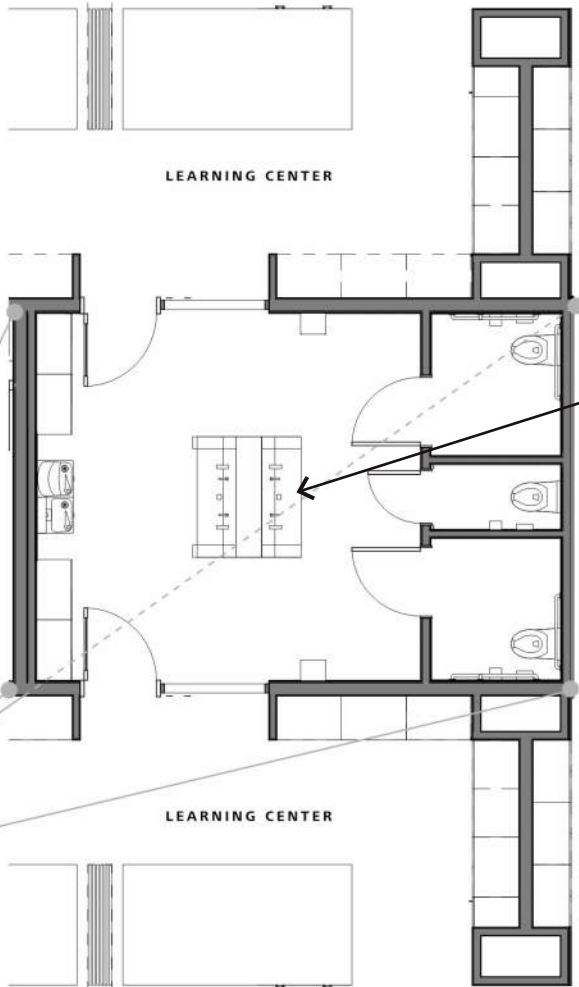

ENLARGED PLAN:
LEARNING CENTER TOILETS

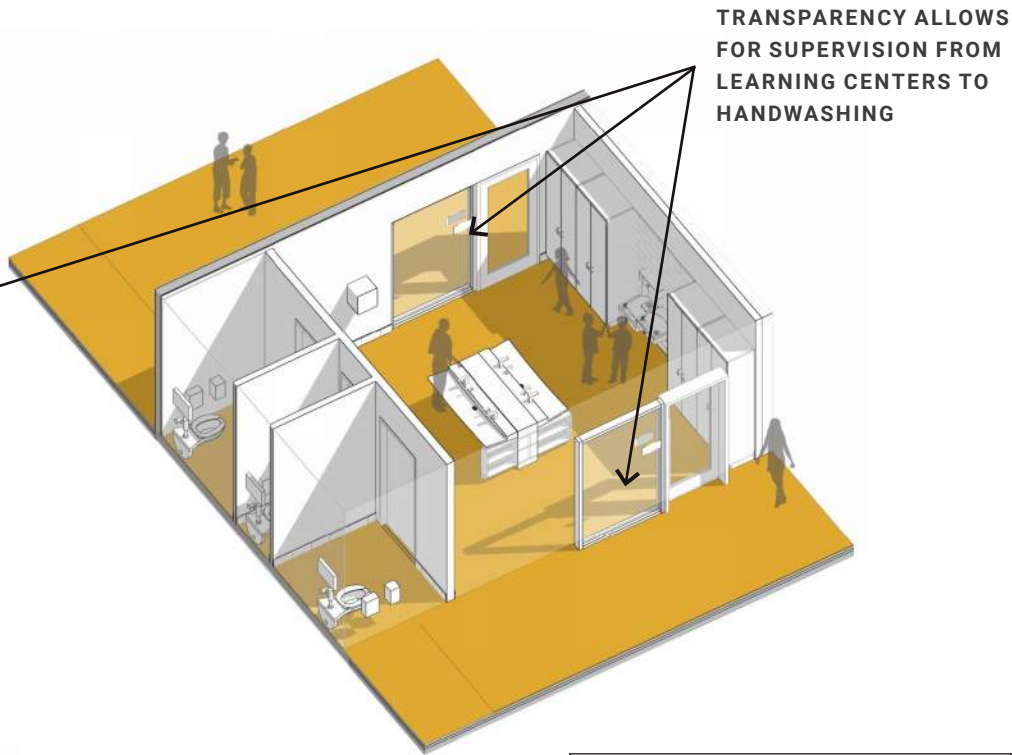

AXONOMETRIC VIEW:
LEARNING CENTER TOILETS



Cultivating Community

Interwoven Ages

- Kindergarten Learning Center
- Primary Learning Center
- Intermediate Learning Center
- Middle School Learning Center



Cultivating Community

Quilt of Learning

- Kindergarten Learning Center
- Primary Learning Center
- Intermediate Learning Center
- Middle School Learning Center
- Outdoor Learning

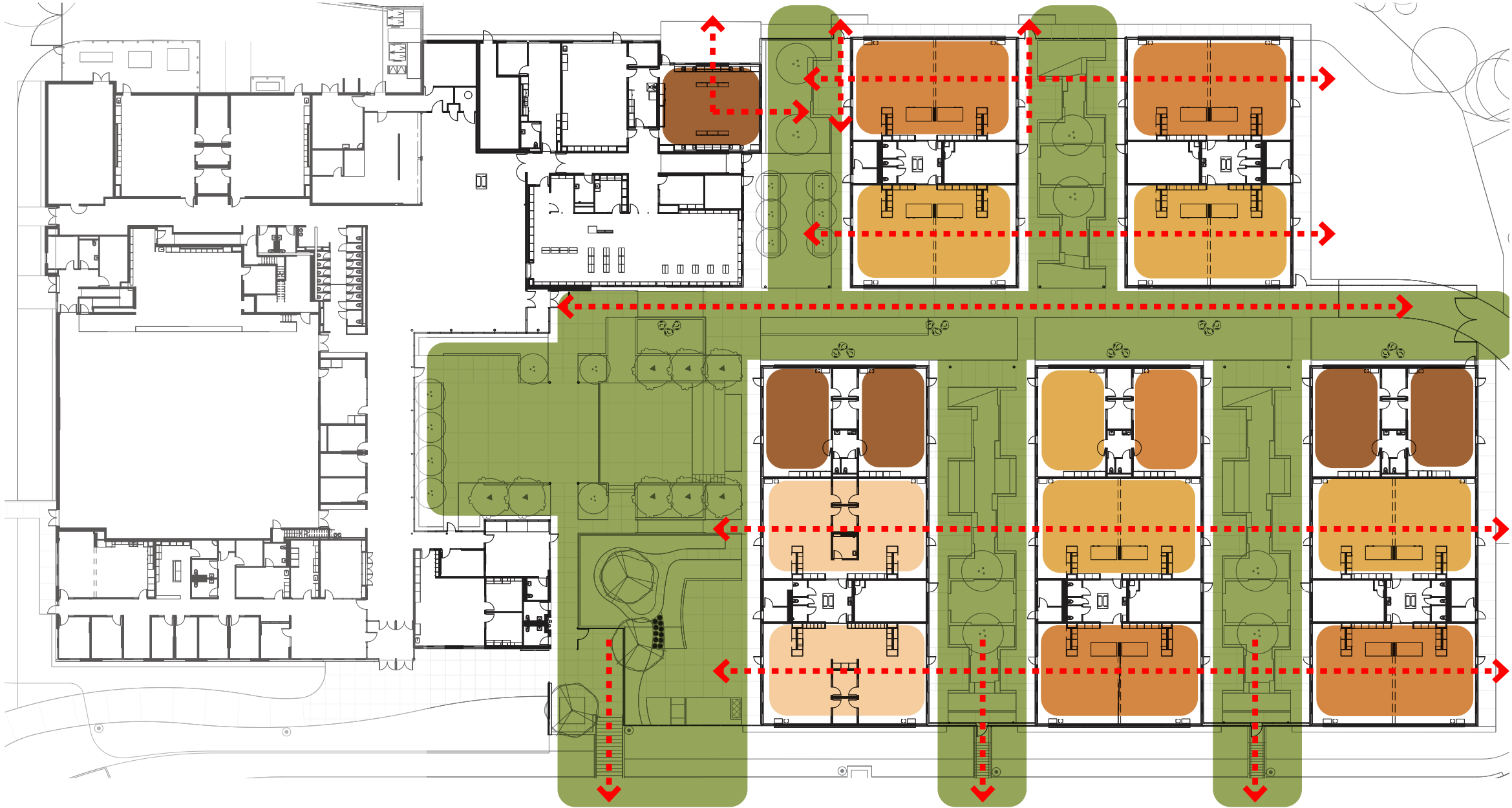

Secure Perimeter

Indoor Outdoor Connectivity

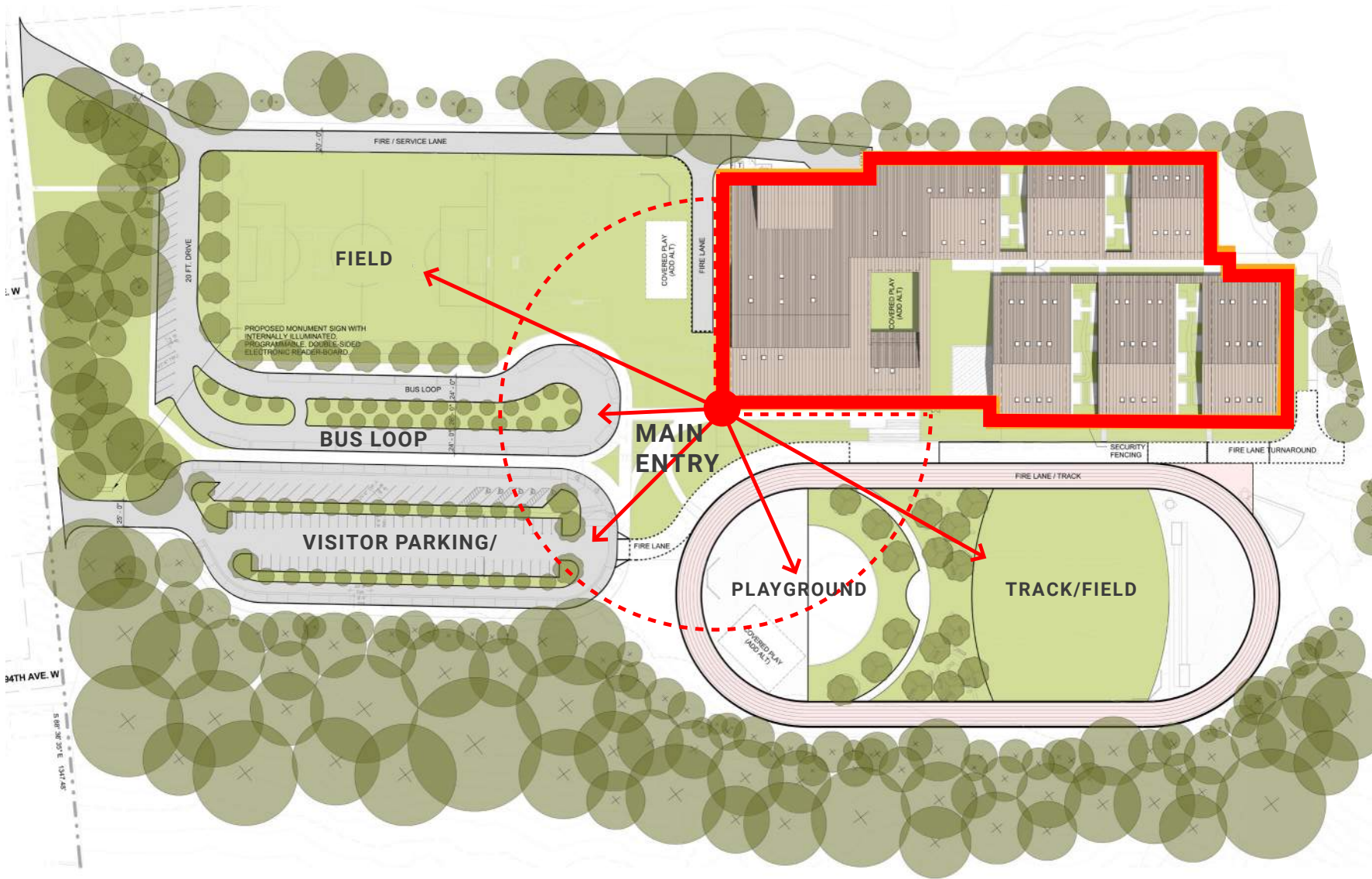

Daylighting and Acoustics



Flexible Learning Environments

Interior - Exterior Connectivity

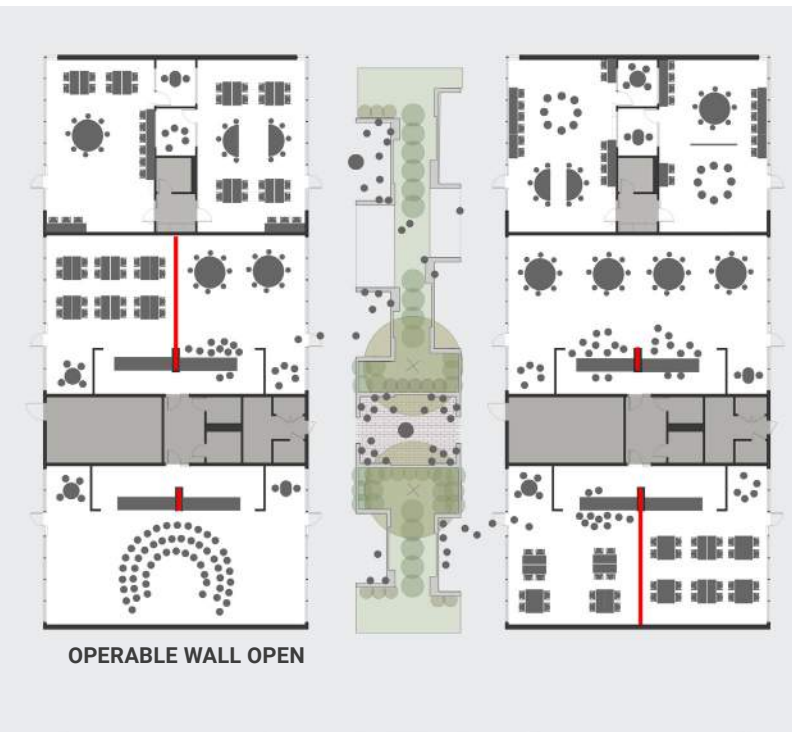

Flexible Learning Environments

Interior - Exterior Connectivity

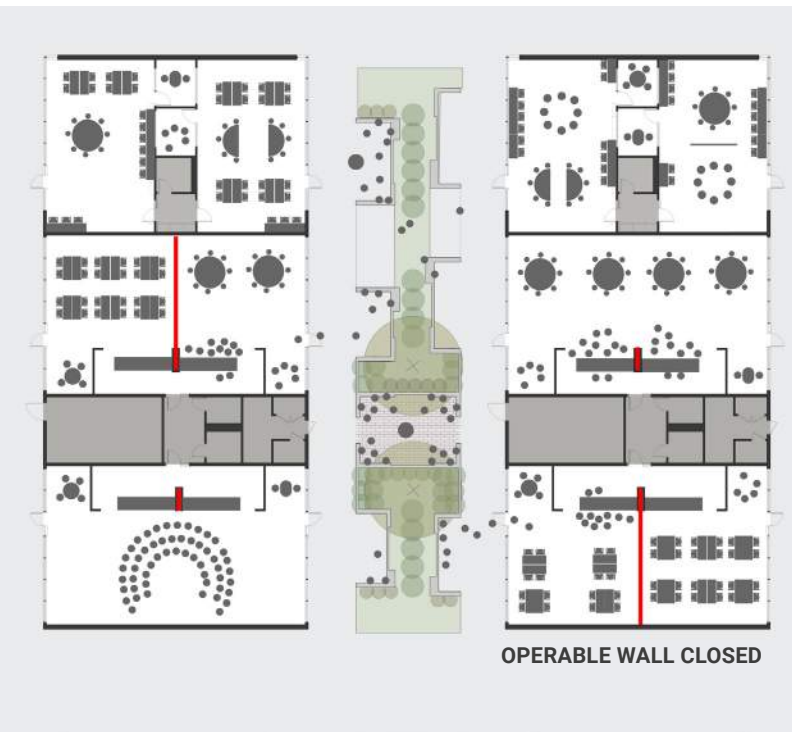

Flexible Learning Environments

Interior - Exterior Connectivity



Flexible Learning Environments

Individual - Small to Large Group



Flexible Learning Environments

Whole Building / School

HEADLINE

Madrona Puts on a Grand Opening Outdoor Concert

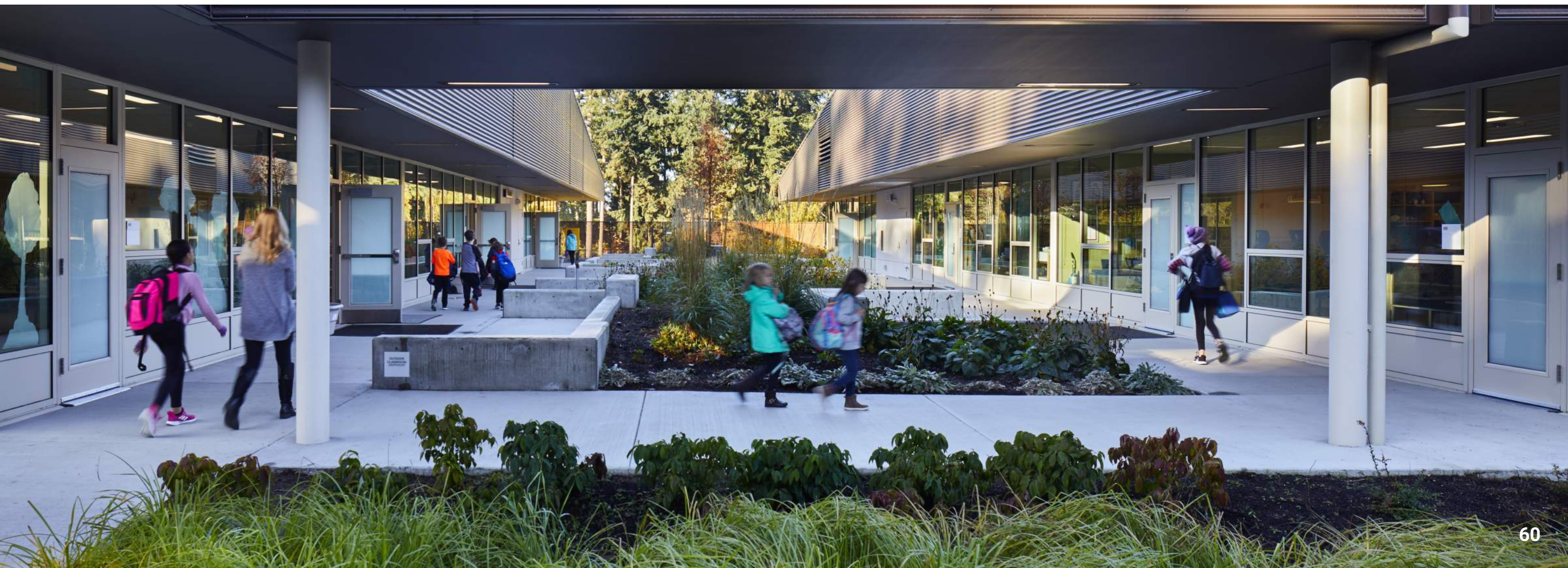
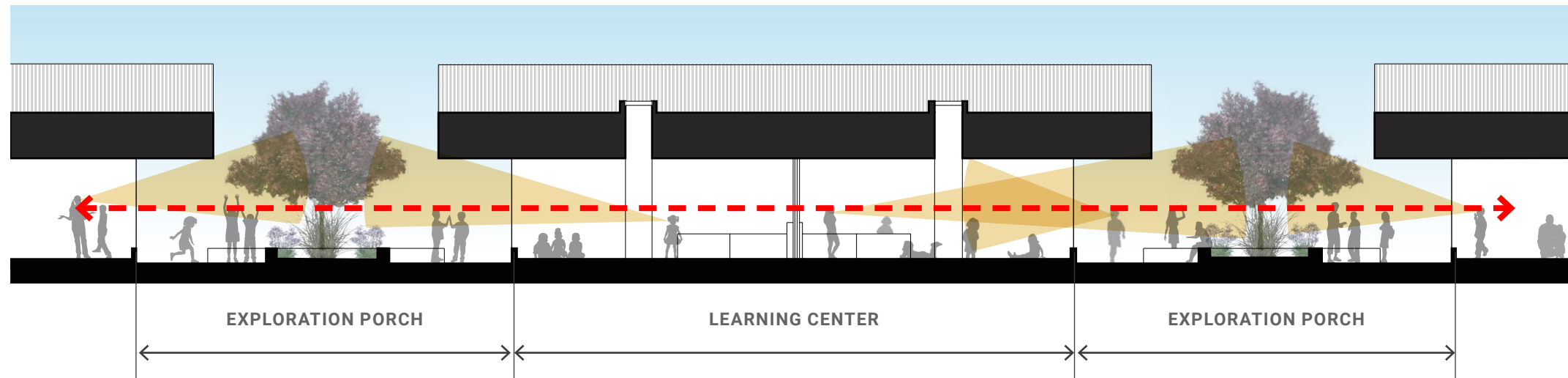

Positive Social Interactions



Respect



Conclusions & Questions

Impact on Future Projects

Design of the next Lake Oswego Middle School



Post Occupancy Evaluation

Educational Specification Updates



Thank you!

Kurt Schultz, Ed.D.

Principal, Lakeridge Middle School,
Lake Oswego School District

Taine Wilton, AIA, ALEP, LEED AP

Capital Projects, Edmonds School District

Abby Dacey AIA LEED AP

Mahlum Architects

Corrie Rosen AIA LEED AP

Mahlum Architects